

APPROVED RESIDENTIAL PUD FOR SALE

SWC EDWARDS RD & 25TH ST NEAR FT. PIERCE, ST. LUCIE COUNTY, FL

REDUCED TO
\$1,100,000



35.26+/- ACRE VACANT LAND PARCEL LOCATED NEAR FT. PIERCE IN UNINCORPORATED ST LUCIE COUNTY, PREVIOUSLY PLANNED FOR UP TO 318 RESIDENTIAL UNITS

Other pertinent information:

- Bank-Owned
- Referred to as "Sedona"
- Three assembled parcels containing 35.26+/- Acres
- Site has approvals for 184 Multi-Family Units & 134 Zero Lot Line SF Lots
- Zoning is PUD, Planned Unit Development
- Future Land Use is RM, Medium Density

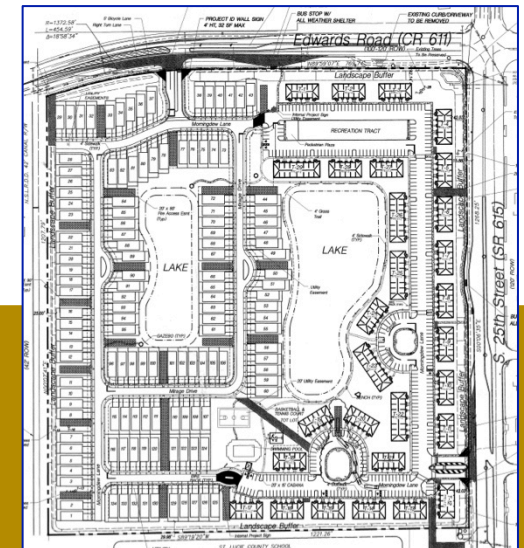

For more information, please contact:

Leslie A. Maister, Broker
leslie@seas-llc.com
Direct: 561.988.5892

K. Reid Hotaling, Broker
reid@seas-llc.com
Direct: 561.988.5894

SOUTHEAST ASSET SPECIALISTS, LLC
951 Broken Sound Parkway, Suite 108, Boca Raton, FL 33487
Phone: 561.988.5890 • Fax: 561.241.5690 • www.seas-llc.com