



# AVAILABLE FOR SALE

**16.96+/- ACRE APPROVED MIXED USE PUD  
SOUTH OF MIDWAY ROAD ALONG THE WEST SIDE OF NW E. TORINO PARKWAY,  
PORT ST. LUCIE, ST. LUCIE COUNTY, FL**



**LAND SIZE:** 16.96+/- ACRES  
**ZONING:** PUD, PLANNED UNIT DEVELOPMENT  
**FUTURE LAND USE:** RM (MEDIUM DENSITY RES), ROI (RESIDENTIAL/OFFICE/INSTITUTIONAL) & CG (COMMERCIAL LIMITED)  
**DESCRIPTION:** VACANT LAND PREVIOUSLY PLANNED FOR 148-UNIT MULTI-FAMILY UNITS

DEMOGRAPHIC PROFILE			
	1 MILE	3 MILE	5 MILE
POPULATION	5,918	27,684	81,267
HOUSEHOLDS	2,113	10,697	31,657
AVE HH INCOME	\$63,757	\$63,815	\$61,288
MEDIAN AGE	36.8	44.5	43.2

**For More Information, please contact:**

## **SOUTHEAST ASSET SPECIALISTS, LLC**

Licensed Real Estate Broker

**Leslie A. Maister, Broker**

leslie@seas-llc.com

Direct: 561.988.5892

**K. Reid Hotaling, Broker**

reid@seas-llc.com

Direct: 561.988.5894

Phone: 561.988.5890 • Fax: 561.241.5690 • [www.seas-llc.com](http://www.seas-llc.com)

*The information contained herein has been obtained from sources believed to be reliable, but no warranty or representation, expressed or implied, is made. All sizes and dimensions are approximate. Any prospective buyer should exercise prudence and verify independently all significant data and property information. This is NOT an offer of sub-agency or co-brokerage.*





# PHOTOGRAPHS

561.988.5890 SOUTHEAST ASSET SPECIALISTS, LLC



SOUTHERN PROPERTY BOUNDARY  
(SITE ON RIGHT)



NW EAST TORINO PARKWAY LOOKING  
NORTHWEST (SITE ON LEFT)



PICTURESQUE PRESERVE ON SITE'S  
WESTERN BOUNDARY



NE CORNER OF SITE AT TORINO/DELWOOD  
INTERSECTION

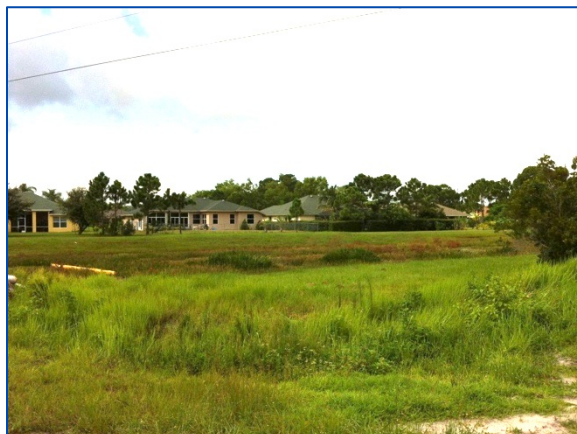

NEIGHBORING SINGLE-FAMILY HOMES DUE SOUTH  
OF SITE



## ZONING

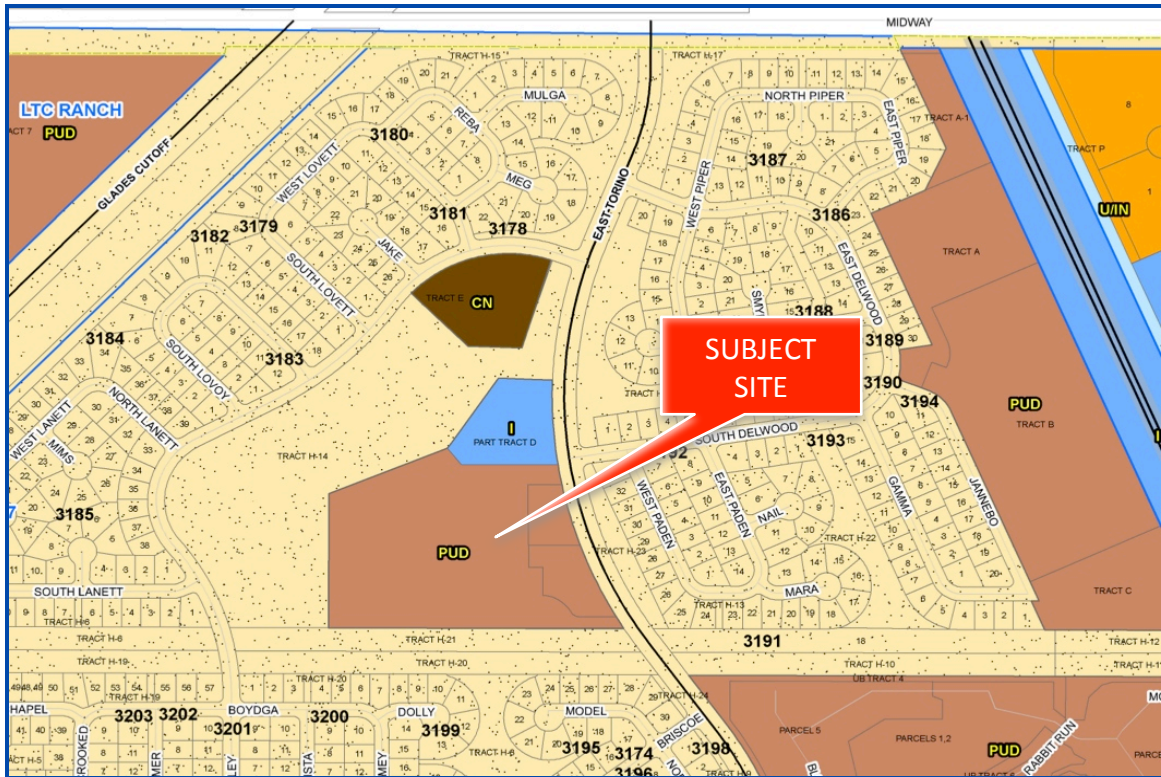

## FUTURE LAND USE

